

FIXTURE INSTALLATION

Important: Read all instructions in order to ensure safety and proper installation. DO NOT operate this product under any conditions other than those for which it is specified. Failure to observe these precautions can lead to electrical shock, product failure, or other problems.

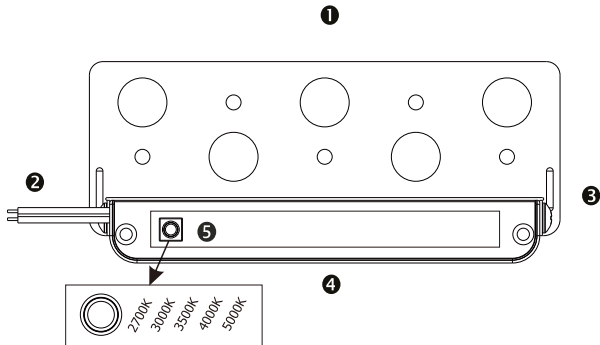

PARTS LIST

- ❶ Mounting Plate
- ❷ Wire
- ❸ Bracket
- ❹ Lamp Body
- ❺ 5CCT Tunable Button

Specification	Power	Voltage	Lumens	Color Temperature	Dimensions	Equivalent to
7" LED Adjustable Light	4.5W	AC/DC 12V-24V	360 LM	5CCT Tunable	173*74*23mm	36W halogen
12" LED Adjustable Light	7W	AC/DC 12V-24V	560 LM	5CCT Tunable	300*74*25mm	56W halogen

MAINTENANCE

READ ALL INSTRUCTIONS IN ORDER TO ENSURE SAFETY AND PROPER INSTALLATION.

1. DO NOT operate this product under ANY conditions other than those specified for it. Failure to observe these precautions can lead to electrical shock, product failure or other problems.
2. TURN OFF THE POWER at the electrical panel before installation or maintenance.
3. DO NOT modify this fixture. ANY modifications may render the product unsafe and void the warranty.
4. This product is rated for outdoor use.

Limited Warranty

The warranty applies to the product from the original date of purchase for three(3) years against manufacturing defects. The owner must provide a copy of the original proof of purchase. The manufacturer's obligation under this warranty is limited to repairing or replacing the component. It is not related in any way to the cost of the connection, the installation of the replacement parts or cost of transport

Package Content

- Low voltage hardscape light x1
- Waterproof wire nuts x2
- Plastic anchors x4(7") / x5(12")
- Countersunk Screws x2
- Round head screws x4(7") / x5(12")

INSTALLATION GUIDE

⚠ WARNING

Turn power OFF from electrical panel before installation or maintenance.

- 1) Turn off power..
- 2) Determine the desired location for each fixture before construction of wall is started.(Fig.1)
- 3) Insert stainless steel mounting plate in between layers of hardscape material. The use of adhesive or mortar (not provided) to secure the fixture in place is optional. (Fig.2)
- 4) Route the fixture wire through the wall to the main low voltage supply cable using standard masonry procedures. A "V" shaped notch can be cut into the hardscape material to aide in wire management if desired.(Fig.3)
- 5) Attach fixture to bracket using screws provided.(Fig.4)
- 6) Connect fixture wires to main low voltage supply cable using the connector(s) provided.(fig.5)

Installation A:

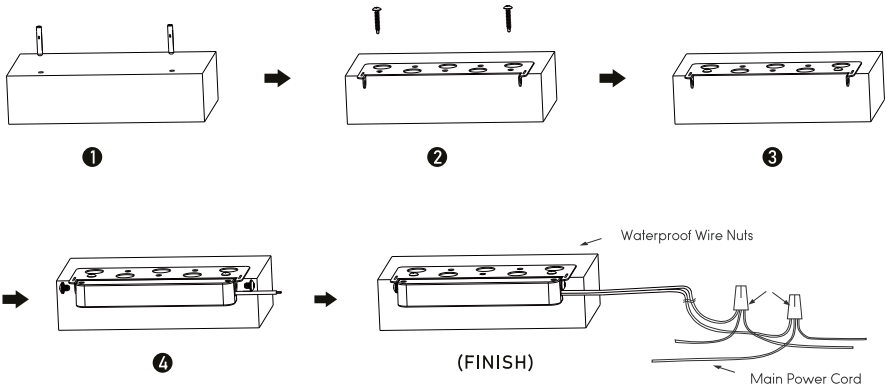

Installation B:

