

Installation Instruction

Cautions:

1. Can not use the electric generator to test the LED lamp.
2. Please abide by related country, regional and local law and regulations where install this fixture.
3. Please turn off the power before installation or maintenance.
4. Proper earth grounding is required to ensure safety.

Notice:

1. To avoid possibility of electrical shock or fire, the installation personnel must have professional electric knowledge.
2. Please wear gloves to avoid injury before installation.
3. If any smoke or spark of the wire happens, please turn off the power immediately and notify relevant personnel.

Special functions instruction:

1. CCT Selectable

- 1). The color temperature of the lamp turns to 3000K when the switch is set to WW (Figure A)
- 2). The color temperature of the lamp turns to 4000K when the switch is set to NW (Figure B)
- 3). The color temperature of the lamp turns to 5000K when the switch is set to CW (Figure C)

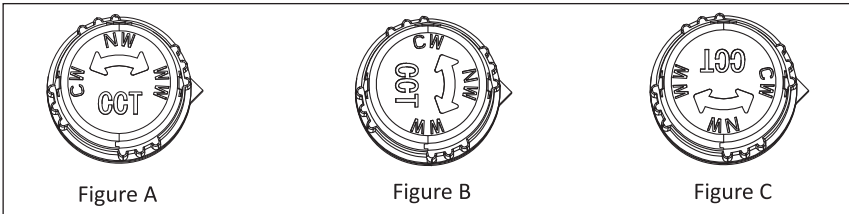

2. Power Selectable

- 1). The power turns to maximum wattage when the switch is set to I (Figure D)
- 2). The power turns to middle wattage when the switch is set to II (Figure E)
- 3). The power turns to minimum wattage when the switch is set to III (Figure F)

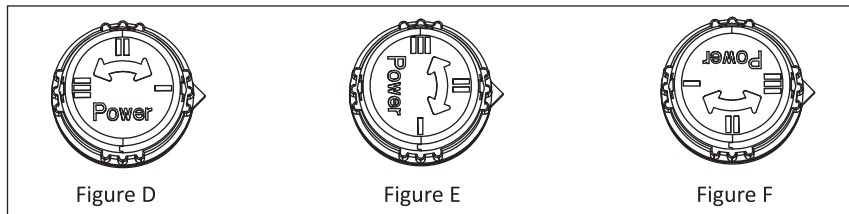

Wiring Diagram:

- ① CCT Selectable Switch
- ② Wattage Selectable Switch
- ③ 0-10V Dimming Wire
- ④ Input Wire AC120-347Vac

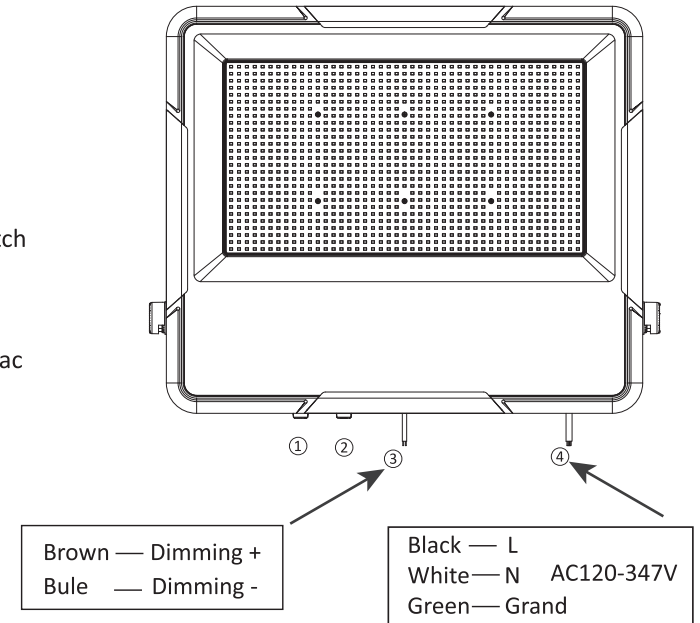

Attention:

1. Please check if there is any damage during shipping. if so, please contact manufacturer timely.
2. Please read this installation instruction carefully to check whether all the accessories are complete.
3. After confirmation, then install the fixture according to installation guide.

Installation Method:

Step 1: Turn off the electrical
(Figure 1)

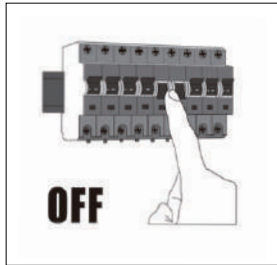

Figure 1

Step 2: Drill the holes on the wall.
(Figure 2)

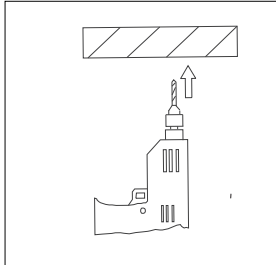

Figure 2

Step 3: Find a proper position for
floodlight (Figure 3)

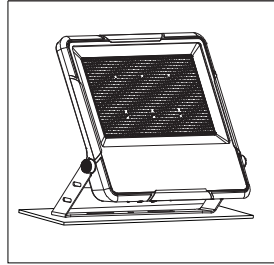

Figure 3

Step 4: Fix the bracket on the wall,
No need to take off the bracket from flood light.
(Figure 4)

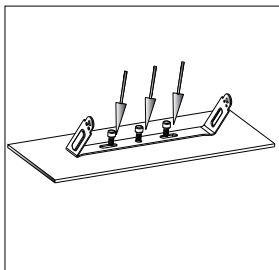

Figure 4

Step 5: Adjust the right angle through the scale angle
Scale angle $\pm 180^\circ$ (Figure 5)

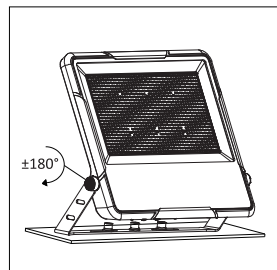

Figure 5

Step 6: Connect the input wire, the connection
Between cables should use IP 68
connectors (Figure 6)

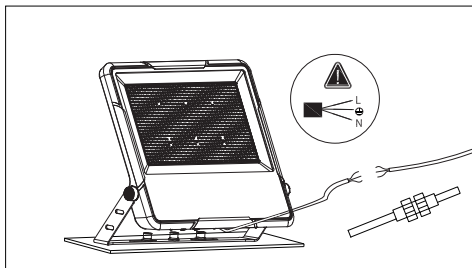

Figure 6

Step 7: Turn on the electrical (Figure 7)

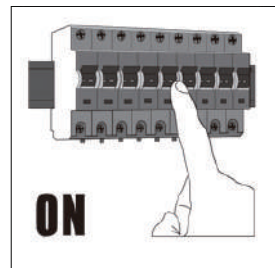

Figure 7

